



# Butlerib II EX™ and Shadowall EX™ Wall Systems

A cost competitive, energy efficient wall system engineered for better building performance



Available in two distinctive panel profiles, the Butler® EX Wall System delivers exceptional energy performance while also providing an architecturally pleasing exterior. The Butlerib II EX™ and Shadowall EX™ Wall Systems address the demands of new energy codes while offering a cost competitive option to Insulated Metal Panels (IMPs). The EX Wall Systems helps you save on your building's heating and cooling costs without sacrificing quality.

## Tested, Proven Results

In 2009, Butler was the first and only metal building company to invest in a Guarded Hot Box to develop newer and more thermally efficient building envelopes.

The BlueScope Guarded Hot Box precisely measures thermal conductance through insulated roof and wall system assemblies, which helps our research and development team create more sustainable, energy-efficient buildings.



The Butler Guarded Hot Box tested actual in-place performance of the EX Wall Systems.

As states adopt new energy codes, buildings are required to have higher-performing insulation systems. The EX Wall Systems, not only deliver these required thermal values but prove their performance as tested in our accredited

Tested U-factor/R-value Chart		
Thermal values as tested and validated by using BlueScope's accredited Guarded Hot Box.		
Wall System	U-factor	Effective R-value
Butlerib II EX System	0.047	21.18
Shadowall EX System	0.046	27.74

Guarded Hot Box. When tested, both EX Wall Systems surpassed the energy ratings of a 2.5" IMP, using 8-inch R-25 insulation, by achieving a U-factor between 0.046 and 0.047. The test results enable Butler Builder® contractors and mechanical engineers to more precisely size heating and cooling units for the lowest initial cost and ensure optimum operating efficiency.

## Innovative Design To Meet Energy Codes

The EX Wall Systems utilize an engineered component, a metal stanchion, for their single-skin wall panels to meet the stricter energy code requirements for metal building walls. This exclusive stanchion allows for more insulation between the structural girt and the wall panel, thereby improving thermal performance. The metal stanchions attach on top of the fiberglass insulation and hold it in place

during installation, making it easier to assemble.

## Quality Appearance For The Decades

The Butlerib II EX and Shadowall EX wall systems use the high-quality Butler-Cote™ premium finish. Comprised of a 70-percent Kynar 500® or Hylar 5000® resin, this incredibly durable Fluoropon® coating holds a 25-year warranty against blistering, peeling, cracking, or chipping of the paint finish.



# Butlerib II EX™ and Shadowall EX™ Wall Systems

1. Eave Strut
2. Insulation
3. Girt
4. Stanchion
5. Base Trim
6. Shadowall™ Panel
7. Butlerib® II Panel

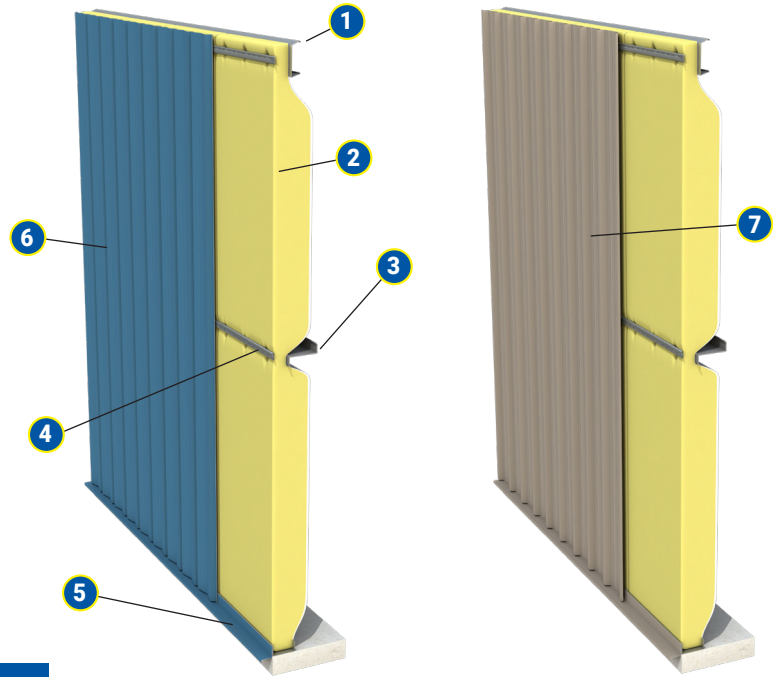

## The Butler Difference

Butler Builders provide complete construction services with single-source responsibility

- Reputable professionals with extensive knowledge of local building codes

Maximize your building's performance with a complete Butler® system solution

- Innovative structural, wall and roof systems
- Precision-engineered for seamless integration



## Key Benefits

- Exceeds the energy performance of a 2.5" IMP, making it an ideal option where energy efficiency is a chief concern.
- Provides a cost-competitive solution over other insulated wall systems.
- Unlike IMPs, the panels are lightweight and more manageable for crews to handle without the need for special equipment.
- Metal stanchions hold fiberglass insulation in place during installation, making it easier to assemble.
- Metal stanchions provide a high quality, seamless appearance by eliminating insulation compression issues.
- You benefit from lower transportation costs for single-skin wall panels and stanchion parts when compared to IMPs, which is inherently freight sensitive.

Butler Manufacturing  
Kansas City, MO  
816-968-3000

[www.butlermfg.com](http://www.butlermfg.com)

Butler® building products are constantly being improved; therefore, the information contained herein is subject to change without notice. Before finalizing project details, contact your nearest Butler Builder® or Butler Manufacturing™ for the latest information. Galvalume is a registered trademark of BIEC International, Inc. USGBC logo is a registered trademark owned by the U.S. Green Building Council and is used by permission. IAS is a subsidiary company of the International Code Council.

© 2020 BlueScope Buildings North America, Inc. All rights reserved. Butler Manufacturing™ is a division of BlueScope Buildings North America, Inc. Find your independent Butler Builder® at [www.butlerbuilder.com](http://www.butlerbuilder.com). Form No.6597 11/20